



Status: Move-in Ready



## 29 Parmelia Close, Ellenbrook

Offers from \$760,000

Frontage 10.5m

Land size 364m<sup>2</sup>

- Upgraded kitchen with 900mm appliances and overhead cupboards
- Built by Dale Alcock Projects
- Designed to Livable Housing Gold Standard
- Ducted air conditioning
- 3KW solar power system
- High 31c ceilings
- Front and backyard landscaping
- Vinyl flooring throughout
- Strata levies of \$501.50 (inc. GST.) per quarter
- Water rates \$537.10(1st July - 31st Dec 2025)

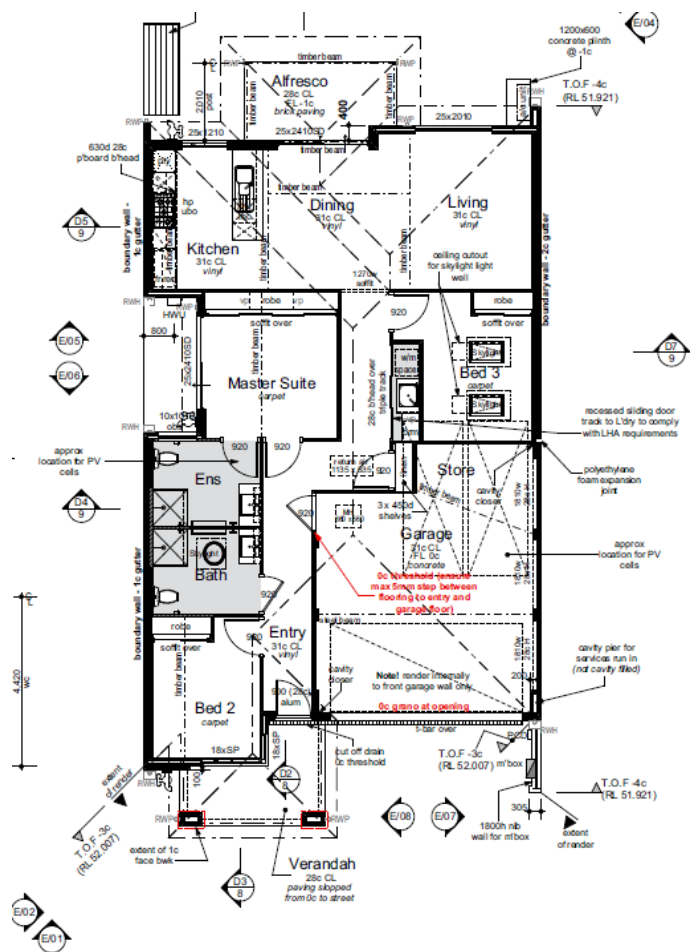

### For more information



**Joshua Knapton**  
0487 700 446  
info@ellengardens.com.au

